

## A COMPACT AND VERSATILE FORCED-AIR HEATER!

This unit is designed for places with limited wall space. Since it works with forced air, it's ideal for entrance halls near the front door, to quickly warm the cold air that enters every time the door opens.

# Compact Wall Heater

## QUIETER

For better control of air flow and noise level, unit motors vary in accordance with power ratings.

- The 500W and 1000W models are equipped with a 40 cfm motor, which emits a sound level of approximately 38 dBA.
- The 1500W and 2000W are fitted with a 80 cfm motor, which emits a sound level of approximately 41 dBA.

## VERSATILE

- Provides four different mounting positions to accommodate any installation.

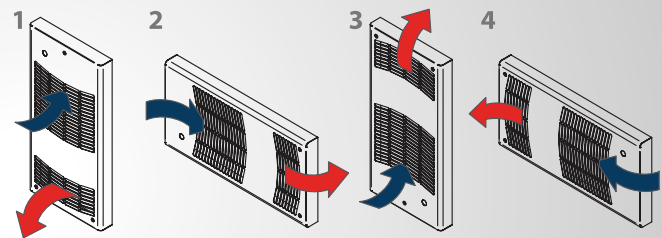

- Can be recessed in a 2 in. X 4 in. or 2 in. X 3 in. wall space or even on the wall surface with a surface mounting box that is sold separately.



## Compact Wall Heater

Watts	Heats an area of about <sup>1</sup>	
	sq. ft.	sq. m
500	50	4.65
1000	100	9.29
1500	150	13.94
2000	200	18.58

<sup>1</sup> Intended as a guide only. These calculations are based on a room with an 8 foot ceiling, R12 wall insulation and R20 ceiling insulation. The suggested heating capacity would then be able to keep the room temperature at 21 °C (70 °F) when the outdoor temperature is at -25 °C (-13 °F). The heating capacity required will vary depending on the area and volume of the room, the layout and orientation of the residence, its geographic location, type of construction, insulation and airtightness levels, as well as the size, type and orientation of the windows, etc.



**Quiet unit**



**Sturdy construction**



**Versatile**